

Antibody Detection Kit CANINE IgE

Cat. No. 85CIE105/85CIE150
INSTRUCTION MANUAL

I. Intended Use of the Kit

ImmunoRun Canine IgE Ab detection kit is intended for qualitative detection of total IgE in canine serum. The kit contains all components required to perform the test.

II. General Information

ImmunoRun Canine IgE Ab Detection kit contains individual devices intended for performing immunochromatographic assay to qualitatively detect total IgE in canine serum. Each device contains 2 main windows. A Sample window (marked S) which is the specimen application well and a square result window marked by 2 letters: "T" marks the test line and "C" marks the control line (See Fig. 1). Both lines are invisible before reaction takes place. The control purple line should appear with each ongoing reaction as it is used for validation of the test. The specially selected anti-canine IgE is used in the test band as both capture and detector materials. These enable the Anigen Rapid Total IgE Test Kit to identify canine IgE in canine serum with a high degree of accuracy.

Fig. 1: IgE Ab. device

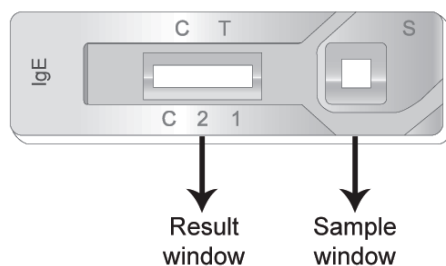

III. Description of Detected Component

There are five isotypes of Immunoglobulins (IgM, IgD, IgG, IgE and IgA). IgE in Canine serum is an immunoglobulin, which is responsible for Mast cells activation (immediate hypersensitivity).

Since IgE also plays an important role in type I hypersensitivity, elevation in IgE level occurs in allergy reactions.

The ImmunoRun IgE Antibody Detection Kit is the simplest screening diagnostic method available to detect the presence of Immunoglobulin of isotype E. Due to IgE main function in immunity to parasitic worms and

certain protozoan parasites, elevation in IgE is expected when the dog has parasite infestation.

For best results strict adherence to the following step by step protocol is required.

IV. Kit Contents

Component	5 Tests Kit (85CIE105)	50 Tests Kit (85CIE150)
IgE Ab test device	5	50
Sample collection tubes containing assay diluent	5	50
Disposable droppers	5	50
Disposable capillary tube with a 10µl marked line (See Fig. 2)	5	50
Instruction manual	1	1

Fig. 2: 10µl marked line on a capillary tube



V. Storage and Handling

- Shipment may be performed at room temperature.
- Store at 2-30°C (room temperature or refrigerated). Avoid exposure to direct sunlight.
- **Do not freeze!**
- The test kit is stable through the expiration date marked on the package label, do not use beyond expiration date.
- Do not open or remove test kit from their individually sealed pouches until immediately before their use (do not use kit if the pouch or the device are damaged).
- Avoid touching exposed membrane in device windows.
- Components in this kit have been quality control approved as standard batch unit. Each component in the kit is for a single use only. Do not mix components from different lot numbers, and do not try to reuse a device.
- Handle and dispose of used samples, swabs, extraction buffer and used device in accordance with accepted sanitary requirements designated for biohazardous waste.

For further information and assistance please contact your local distributor or Biogal Galed Labs. Acs. Ltd. Directly by e-mail: info@biogal.co.il or by tel: 972-4-9898605 / fax: 972-4-9898690.

VI. Step by Step Protocol

For best results, strict adherence to these instructions is required.

Sample Preparation:

1. Only canine serum should be used with this test.
2. Collect blood from dog.
3. If the test is delayed, centrifuge sample in order to separate serum from other blood components and store refrigerated (2-8°C) for up to 72 hours, or freeze (below -20°C) for a longer period.
4. Specimens containing precipitate may yield inconsistent results. Such specimens must be clarified by centrifugation prior to assaying.
5. Using the disposable capillary tube, add 10 µl of serum into assay diluent bottle. Cap the diluent bottle and mix thoroughly by inverting it a few times. (Figure 3)

Fig.3: Sample preparation

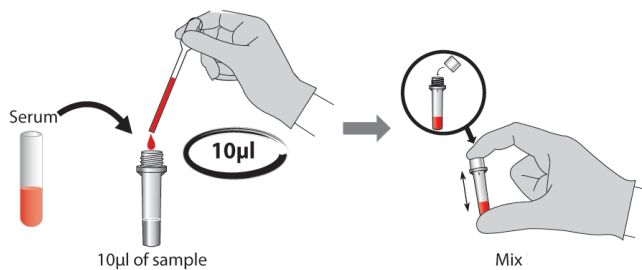

Test Protocol:

1. If stored refrigerated, allow all kit components and specimen to reach room temperature prior to testing.
2. Remove the test cassette from the foil pouch prior to use. Place it horizontally on a dry surface.
3. Using the disposable dropper, slowly apply 4 drops of the diluted sample into the sample well, 1 drop at a time (Figure 4).

Fig.4: Application of diluted sample with disposable dropper

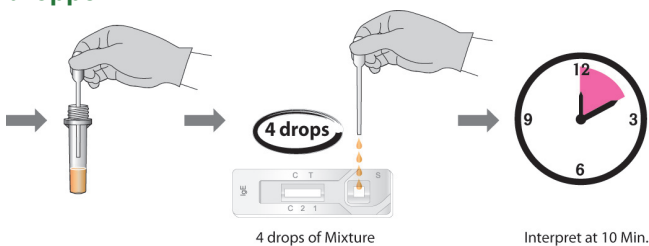

4. Follow the control line ("C") as it appears in the result window. In case of a positive result, a test line ("T") should appear as well.
5. Reading test results must be done within 10 minutes of sample application.

VII. Reading and Interpreting the Results

- See Fig. 5.
- The presence of (any) **two** visible bands: the test band ("T") and the control band ("C") within the result window (no matter which band appears first)

indicates a **positive** result, regardless of test band intensity.

- A lack of a test band, while control band is present within the result window, indicates a **negative** result.
- If the control band is not visible within the result window, the result is considered **invalid** (even if the test band appears).

Fig.5: IgE Ab. bands interpretation

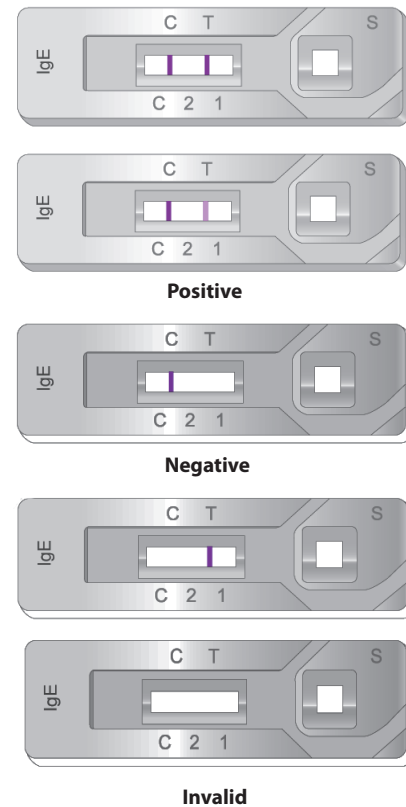

VIII. Limitations and Troubleshooting

- For veterinary in vitro use only. Do not use internally or externally in humans or animals.
- Negative result means that total IgE concentration is below 10ug/ml in canine serum, not necessarily means that the dog is free of allergy. Other clinically available tests are required if questionable results are obtained. As with all diagnostic tests, a definitive clinical diagnosis should not be based on the results of a single test, but should only be made by the veterinarian after all clinical and laboratory findings have been evaluated.
- This test is qualitative test kit. Test line density may not be proportional to IgE concentration in canine blood.
- Steroids or antihistamine medications may affect test result. Two weeks of withdrawal period is required before running the test.
- Parasite infection should be cleared before the test.

IX. References

- Abul K. Abbas & Andrew H. Lichtman - Basic Immunology.



Biogal – Galed Labs. Acs. Ltd.
Tel: 972-4-9898605 | Fax: 972-4-9898690
E-mail: info@biogal.co.il | Site: www.biogal.co.il